



Alex & Matteo
ESTATE AGENTS



Alex & Matteo
ESTATE AGENTS



Alex & Matteo
ESTATE AGENTS

Freda Street, London, SE16 4ED

A modern two bedroom apartment, located a short walk away from Bermondsey underground station and Tower Bridge. The apartment boasts a spacious kitchen and reception room with access to a private balcony and plenty of storage, a sleek family bathroom, two double bedrooms with built-in storage and one features an en-suite bathroom. Additional storage can be found in the hallway. The property is surrounded by many local amenities such as restaurants, bars, local markets, grocery stores, cafes, and Southwark Park. This apartment also has excellent transport links to central London.

- Generous Two Bedroom Apartment
- Excellent Location
- Good Transport Links
- Furnished
- Within Walking Distance of Local Amenities

Alex & Matteo
ESTATE AGENTS

£2,600 Per month

Parker Building SE16

Approximate Area = 803 sq ft / 74.5 sq m

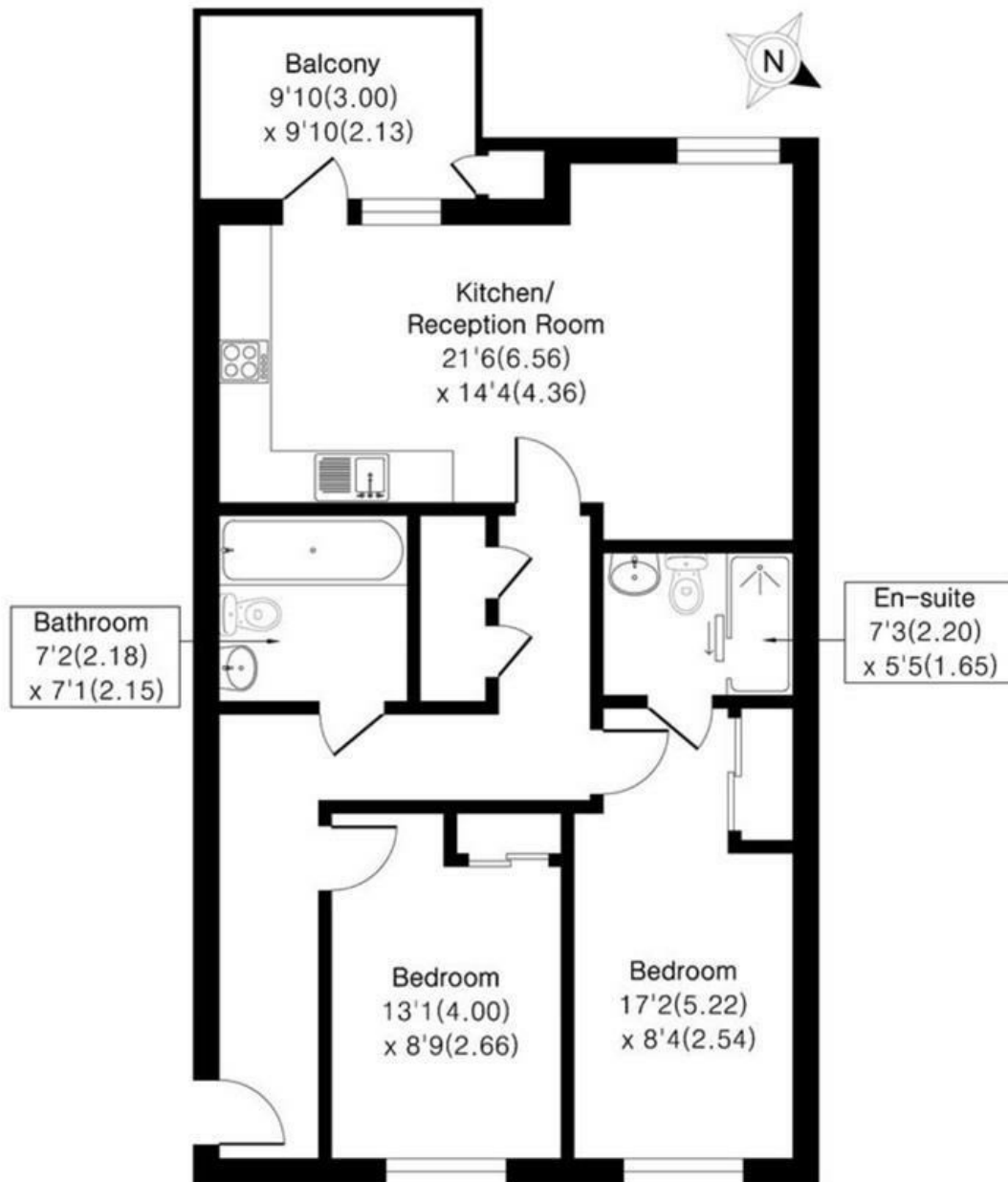

Fourth Floor



Floor plan Produced in accordance with RICS Property Measurement 2nd Edition.
Incorporating International Property Measurement Standards (IPMS2 Residential).
Produced for Alex & Matteo Estate Agents.

Energy Efficiency Rating		
	Current	Potential
Very energy efficient - lower running costs		
(92 plus) A		
(81-91) B	88	88
(69-80) C		
(55-68) D		
(39-54) E		
(21-38) F		
(1-20) G		
Not energy efficient - higher running costs		
England & Wales	EU Directive 2002/91/EC	